

Stock Code: **50012LEDD-WH/CLR**

Collection: Transformer RND

### PRODUCT INFORMATION

Base: 50012 Parent: 50012LEDD  
Mounting Type: Ceiling UPC: 641594248746  
Finish: White  
Diffuser: Clear

### PRODUCT MEASUREMENTS

FIXTURE**	BACKPLATE / CANOPY**
Length:	Length
Width:	Width:
Diameter 2.00"	Diameter: 4.75"
Height: 8.25"	Height: 0.5"
Extension:	
Overall Height:	

### TECHNICAL SPECIFICATIONS

#### SPECIFICATIONS

Frame Material: Aluminum  
Diffuser Material: Glass  
Lamping Type: SSL (Dedicated LED) Jbox: Pancake  
Lamping Base: SSL Lamp Wattage: 11 W  
Lamp Quantity: 1 Total Wattage: 11 W  
Voltage: 120v Lamps Included: Yes

#### QUALIFICATIONS

Location Rating Damp  
Certification: UL (US/Canada) Listed  
ADA Compliant: No Energy Star: No  
JA8 Compliant: Yes Emergency Lighting: No  
Marine Grade Finish: No  
Warranty\*: 5 Year

#### PHOTOMETRICS

Dimmable: Yes Nominal Lumens: 1200 Lm  
CRI: 90 Delivered Lumens: 985 Lm  
CCT: 3000K  
Recommended Dimmers:  
(TRIAC)LUTRON Skylark S-600 or S-600P; (TRIAC)LEVITON Sureslide 6633-P; (TRIAC)LEVITON Sureslide 6631;  
(ELV)LUTRON Skylark SELV-300P; (ELV)LUTRON Diva DVELV-300P; (ELV)LEVITON Illumatech SLIDE IPE04-1LZ

#### ADDITIONAL NOTES

Project Name: \_\_\_\_\_  
Location: \_\_\_\_\_  
Type: \_\_\_\_\_  
Quantity: \_\_\_\_\_  
Notes: \_\_\_\_\_



#### LINE DRAWING

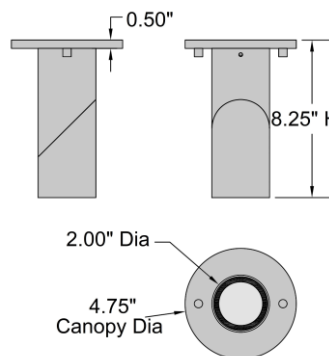

#### IES FILE

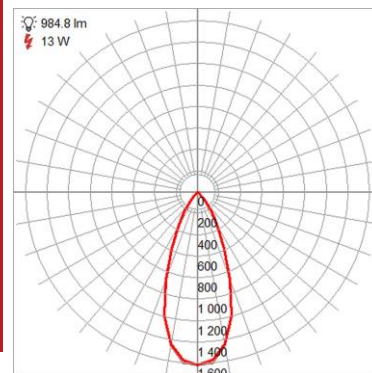

In addition to Access Lighting's purchase and warranty terms and conditions, by signing below or placing an order, you agree that you are authorized to bind the entity placing any order and acknowledge the following: All of sizes and measurements are approximate and all images are for illustrative purposes only. In the event of an inconsistency, the "Product Measurements" section controls. There also may be slight differences in the colors and designs compared to the displayed and printed images.

Signature: \_\_\_\_\_

Print Name \_\_\_\_\_ Date: \_\_\_\_\_

**Toll Free 800-828-5483 www.AccessLighting.com**

301 Piedmont Grove Park, Suite A, Greenville, SC 29611

\*\* NOTE: All measurements are rounded up to the 1/4 inch. There is no warranty on any replaceable bulbs, even if included with the fixture.  
Copyright Access Lighting Corp. All information is subject to change without notice.

2/18/2024

50012LEDD-WH\_CLR.pdf

**access**  
LIGHTING